



ADDENDUM #5
DSA # 01-117794
Pioneer ES New Classroom Addition
DSA File # 1-25

DSA #01-118098
Pioneer ES Interim Housing
DSA File #- 1-25

May 29, 2019

Project: **Pioneer ES New Classroom Addition**
Pioneer ES Interim Housing
32737 Bel Aire St
Union City, CA 94587

Owner: **New Haven Unified School District**
34200 Alvarado-Niles Rd
Union City, CA 94587

Architect: **SVA Architects**
2335 Broadway, Suite 301
Oakland, CA 94612

Note: The following revisions and clarifications to the Bid Documents shall become a part of the Contract Documents prior to Bid. The narrative descriptions listed for the changes are provided for general reference as to the revisions, and each revised drawing included shall be reviewed for the full extent of revisions.

1. BID DATE

- A. Revise the bid opening date from May 30, 2019 at 2:00 pm to June 5, 2019 at 2:00 pm.

2. PROJECT MANUAL

- A. Replace bid form Document 00140 with the attached bid form Document 00140.
- B. Section 01 11 00 Summary of Work

- 1. Revise paragraph 1.4 B.1 to read:

Pioneer ES Classroom Addition

Addendum 5
May 29, 2019
Page 2 of 2



“1. Interim Housing Building Pad Work: A separate contract will be awarded for temporary classroom building pad preparation, earthwork, storm drain and paving work associated with the Pioneer Elementary School Interim Housing project, DSA Application number 01-118098.”

3. ARCHITECTURAL – PIONEER ES NEW CLASSROOM ADDITION (DSA A# 01-117794)

A. Sheet GEN-7

1. Delete note 3 from detail 9.

B. Sheet A01.1 Site Plan

1. Revise site plan keynote S7 to read, “(N) ACCESSIBLE PASSENGER DROP OFF PER DETAIL 9/GEN-7. THIS WORK AND ASSOCIATED PATH OF TRAVEL WORK TO BE COMPLETED PRIOR TO AUGUST 12, 2019.”

4. ARCHITECTURAL – PIONEER ES INTERIM HOUSING (DSA A# 01-118098)

A. Sheet GEN-5

1. Delete detail 8.

5. ELECTRICAL – PIONEER ES INTERIM HOUSING (DSA A# 01-118098)

A. Sheet E01.1

1. Replace sheet E01.1 with the attached Addendum 5 sheet E01.1
2. Revisions:
 - i. Reference attached TK1SC letter dated 5/29/19.

Attachments:

Document 00140 Bid Form
Sheet E01.1 Site Electrical Plan

Distribution: Bidders
Owner
Project Inspector

END OF ADDENDUM #5

May 29, 2019

SVA Architects
2335 Broadway #301
Oakland, CA 94612

Re: **Pioneer Elementary School – Interim Housing**
tk1sc Project # 2018-0621

The following is an Addendum to the above referenced project:

Drawings:

Sheet E01.1 – Site Electrical Plan:

1. Revised site conduit routing per revised sheet E01.1.
2. Added plan notes 19 and 20.
3. Revised plan note 18.

If you have any questions, or require further clarification, please do not hesitate to contact me.

Sincerely,
tk1sc

Andrea Lawson
Senior Engineer - Electrical

BV/al

P:\2018\2018-0621 Pioneer ES Modern New Clstrm Bldg\Correspondence\Letters and Memos\2019-05-17 Addendum 1 Interim Housing.docx

BID FORM AND PROPOSAL

To: Governing Board of New Haven Unified School District (“District” or “Owner”)

From: _____
(Proper Name of Bidder)

The undersigned declares that the Contract Documents including, without limitation, the Notice to Bidders and the Instructions to Bidders have been read and agrees and proposes to furnish all necessary labor, materials, and equipment to perform and furnish all work in accordance with the terms and conditions of the Contract Documents, including, without limitation, the Drawings and Specifications of Bid No. #707

**PROJECT: PIONEER ELEMENTARY
NEW CLASSROOM ADDITION & MODERIZATION**

(“Project” or “Contract”) and will accept in full payment for that Work the following total lump sum amount, all taxes included:

BASE BID
_____ dollars \$ _____
TOTAL: \$ _____

Additive/Deductive Alternates: [NA]
ALTERNATIVES
_____ dollars \$ _____
TOTAL: \$ _____

Descriptions of alternates are primarily scope definitions and do not necessarily detail the full range of materials and processes needed to complete the construction.

1. The Bidder’s Base Bid includes the following unit prices, which the Bidder must provide;
 - **NA**
2. The Bidder’s base bid includes the following allowances:
 - **Contingency Allowance equal to \$75,000.00 Any unused moneys from this allowance shall be returned to the District.**
3. The undersigned has reviewed the Work outlined in the Contract Documents and fully understands the scope of Work required in this Proposal, understands the construction

and project management function(s) is described in the Contract Documents, and that each Bidder who is awarded a contract shall be in fact a prime contractor, not a subcontractor, to the District, and agrees that its Proposal, if accepted by the District, will be the basis for the Bidder to enter into a contract with the District in accordance with the intent of the Contract Documents.

4. The undersigned has notified the District in writing of any discrepancies or omissions or of any doubt, questions, or ambiguities about the meaning of any of the Contract Documents, and has contacted the Construction Manager before bid date to verify the issuance of any clarifying Addenda.
5. The undersigned agrees to commence work under this Contract on the date established in the Contract Documents and to complete all work within the time specified in the Contract Documents.
6. The liquidated damages clause of the General Conditions and Agreement is hereby acknowledged.
7. It is understood that the District reserves the right to reject this bid and that the bid shall remain open to acceptance and is irrevocable for a period of ninety (90) days.
8. The following documents are attached hereto:
 - The Bid Bond on the District's form or other security
 - The Designated Subcontractors List
 - The Site-Visit Certification
 - The Noncollusion Affidavit

- Receipt and acceptance of the following bid documents and addenda is hereby acknowledged:

Pioneer ES New Classroom Addition DSA Approved Drawings (DSA Application Number 01-117794)

Pioneer ES New Classroom Addition DSA Approved Project Manual Including Specifications (DSA Application Number 01-117794)

Pioneer ES New Classroom Addition Project Manual (Project Number #707)
[Documents issued by District]

Pioneer ES Interim Housing DSA Approved Drawings (DSA Application Number 01-118098)

Notice to Bidders

Addendum No. 1A, Dated May 2, 2019

Addendum No. 1B, Dated May 2, 2019

Addendum No. 2, Dated May 17, 2019

Addendum No. 3, Dated May 24, 2019

Addendum No. 4, Dated May 25, 2019

Addendum No. 5, Dated May 29, 2019

Geotechnical Engineering and Geologic Hazards Study for the Pioneer Elementary School New Classroom Buildings, dated September 10, 2018

9. Bidder acknowledges that the license required for performance of the Work is a A or B license.
10. The undersigned hereby certifies that Bidder is able to furnish labor that can work in harmony with all other elements of labor employed or to be employed on the Work.
11. Bidder specifically acknowledges and understands that if it is awarded the Contract, that it shall perform the Work of the Project while complying with all the applicable provisions of the District's labor compliance program.
12. The Bidder represents that it is competent, knowledgeable, and has special skills with respect to the nature, extent, and inherent conditions of the Work to be performed. Bidder further acknowledges that there are certain peculiar and inherent conditions existent in the construction of the Work that may create, during the Work, unusual or peculiar unsafe conditions hazardous to persons and property.
13. Bidder expressly acknowledges that it is aware of such peculiar risks and that it has the skill and experience to foresee and to adopt protective measures to adequately and safely perform the Work with respect to such hazards.
14. Bidder expressly acknowledges that it is aware that if a false claim is knowingly submitted (as the terms "claim" and "knowingly" are defined in the California False Claims Act, Cal. Gov. Code, §12650 et seq.), the District will be entitled to civil remedies set forth in the California False Claim Act. It may also be considered fraud and the Contractor may be subject to criminal prosecution.

15. The undersigned Bidder certifies that it is, at the time of bidding, and shall be throughout the period of the contract, licensed by the State of California to do the type of work required under the terms of the Contract Documents. Bidder further certifies that it is regularly engaged in the general class and type of work called for in the Contract Documents.

Furthermore, Bidder hereby certifies to the District that all representations, certifications, and statements made by Bidder, as set forth in this bid form, are true and correct and are made under penalty of perjury.

Dated this _____ day of _____ 20 ____

Name of Bidder _____

Type of Organization _____

Signed by _____

Title of Signer _____

Address of Bidder _____

Taxpayer's Identification No. of Bidder _____

Telephone Number _____

Fax Number _____

E-mail _____ Web page _____

Contractor's License No(s): No.: _____ Class: _____ Expiration Date: _____

No.: _____ Class: _____ Expiration Date: _____

No.: _____ Class: _____ Expiration Date: _____

If Bidder is a corporation, affix corporate seal.

Name of Corporation: _____

President: _____

Secretary: _____

Treasurer: _____

Manager: _____

END OF DOCUMENT

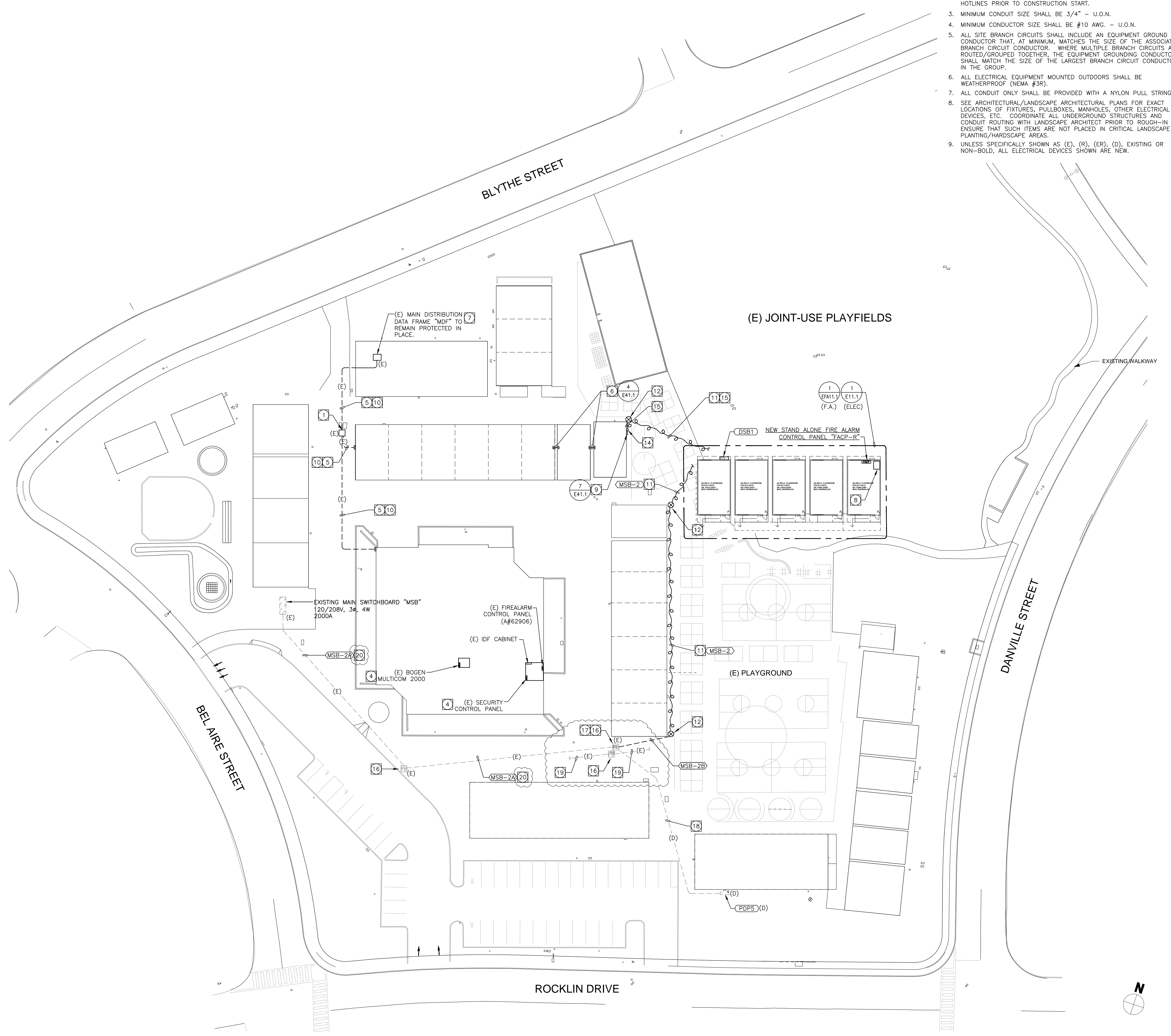

SITE PLAN GENERAL NOTES:

- CONTRACTOR SHALL EXERCISE EXTREME CAUTION IN EXCAVATING AND TRENCHING ON THIS SITE TO AVOID EXISTING DUCTS, PIPING OR CONDUITS, ETC., AND TO PREVENT HAZARDS TO PERSONNEL AND/OR DAMAGE TO EXISTING UNDERGROUND UTILITIES OR STRUCTURES WHETHER OR NOT SHOWN AND INSTALLED BY ANY OTHER CONTRACTS. THE ENGINEER IS NOT RESPONSIBLE FOR THE LOCATION OF UNDERGROUND UTILITIES OR STRUCTURES WHETHER OR NOT SHOWN OR DETAILED AND INSTALLED BY ANY OTHER CONTRACTS. THE CONTRACTOR SHALL IMMEDIATELY NOTIFY THE ENGINEER SHOULD SUCH UNIDENTIFIED CONDITIONS BE DISCOVERED. THESE DRAWINGS AND SPECIFICATIONS DO NOT INCLUDE THE NECESSARY ELEMENTS FOR CONSTRUCTION SAFETY.
- CALL UNDERGROUND SERVICE ALERT (USA) AT 1 (800) 422-4133 OR APPLICABLE STATE AND LOCAL DIG SAFE OR UNDERGROUND ALERT HOTLINES PRIOR TO CONSTRUCTION START.
- MINIMUM CONDUIT SIZE SHALL BE 3/4" - U.O.N.
- MINIMUM CONDUCTOR SIZE SHALL BE #10 AWG. - U.O.N.
- ALL SITE BRANCH CIRCUITS SHALL INCLUDE AN EQUIPMENT GROUND CONDUCTOR THAT, AT MINIMUM, MATCHES THE SIZE OF THE ASSOCIATED BRANCH CIRCUIT CONDUCTOR. WHERE MULTIPLE BRANCH CIRCUITS ARE ROUTED/GROUPED TOGETHER, THE EQUIPMENT GROUNDING CONDUCTOR SHALL MATCH THE SIZE OF THE LARGEST BRANCH CIRCUIT CONDUCTOR IN THE GROUP.
- ALL ELECTRICAL EQUIPMENT MOUNTED OUTDOORS SHALL BE WEATHERPROOF (NEMA #3R).
- ALL CONDUIT ONLY SHALL BE PROVIDED WITH A NYLON PULL STRING.
- SEE ARCHITECTURAL/LANDSCAPE ARCHITECTURAL PLANS FOR EXACT LOCATIONS OF FIXTURES, PULLBOXES, MANHOLES, OTHER ELECTRICAL DEVICES, ETC. COORDINATE ALL UNDERGROUND STRUCTURES AND CONDUIT ROUTING WITH LANDSCAPE ARCHITECT PRIOR TO ROUGH-IN TO ENSURE THAT SUCH ITEMS ARE NOT PLACED IN CRITICAL LANDSCAPE PLANTING/HARDSCAPE AREAS.
- UNLESS SPECIFICALLY SHOWN AS (E), (R), (ER), (D), EXISTING OR NON-BOLD, ALL ELECTRICAL DEVICES SHOWN ARE NEW.

PLAN NOTES:

- EXISTING LOW VOLTAGE SYSTEM PULLBOX TO REMAIN PROTECTED IN PLACE.
- FIRE ALARM SYSTEM WEATHERPROOF SPEAKER. REFER TO FIRE ALARM PLANS FOR ADDITIONAL INFORMATION.
- PROVIDE 2' x 3' x DEPTH AS REQUIRED FLUSH IN GRADE CONCRETE PULL BOX WITH TRAFFIC-RATED BOLT-DOWN COVER LABELED "SIGNAL".
- MODIFY EXISTING HEADEND EQUIPMENT AS REQUIRED TO SERVE THE NEW CONSTRUCTION. PROVIDE ADDITIONAL HARDWARE, CONNECTIONS, ETC., AS NEEDED FOR A COMPLETE AND OPERABLE SYSTEM. VERIFY EXACT LOCATION IN MAIN SIGNAL ROOM IN FIELD.
- EXISTING SIGNAL SYSTEM CONDUITS TO REMAIN. PROVIDE ADDITIONAL DATA FIBER OPTICS, TELEPHONE, PUBLIC ADDRESS, FIRE ALARM, AND CABLE TELEVISION SYSTEM CABLE AS REQUIRED TO SERVE THE NEW CONSTRUCTION.
- PROVIDE THE FOLLOWING SIGNAL SYSTEM CONDUITS WITH CONDUCTORS AS SPECIFIED:
 - 2'C. LAN
 - 2'C. INTRUSION
 - 2'C. PA/CLOCK
 - 2'C.O SPARE.
- MODIFY EXISTING DATA MDF RACK AS REQUIRED TO SERVE THE NEW CONSTRUCTION. PROVIDE ADDITIONAL FIBER ENCLOSURES, PATCH PANELS, CONNECTION, ETC., AS NEEDED FOR A COMPLETE AND OPERABLE SYSTEM.
- NEW IDF CABINET, CONTRACTOR TO VERIFY EXACT LOCATION IN FIELD. REFER TO ENLARGED ELECTRICAL PLAN FOR ADDITIONAL INFORMATION.
- NEMA 3R BOX, SIZE AND QUANTITY PER PLANS, W/ TAMPER RESISTANT.
- WHERE NEW CONDUCTORS/CABLEING IS SPECIFIED IN EXISTING CONDUITS, THE CONTRACTOR SHALL REMOVE ENOUGH OF THE EXISTING CABLEING AS REQUIRED TO PULL IN NEW PLUS REPLACEMENT OF EXISTING REMOVED.
- PROVIDE OVER-HEAD CABLEING ON NEW POLES. PROVIDE 1/4" STAINLESS STEEL AIRCRAFT MESSENGER CABLE PER SEC 398.2 AND 398.30(A) FOR SUPPORT AND ALL NECESSARY SUPPORTS, FITTINGS, LASHINGS, ETC. FOR SUPPORT AS REQUIRED.
- PROVIDE WOOD POWER POLES HEIGHT CLEARANCE TO ALLOW MINIMUM OF 8'-0" ABOVE ROOF TOPS AND 18'-0" OVER ALLEYS AND ROADWAYS WITH VEHICULAR TRAFFIC. CLEARANCES PER NEC 230-24. CONTRACTOR TO INSTALL CROSSBARS AND GUY WIRES AS REQUIRED FOR INSTALLATION.
- ROUTE CONDUIT FROM BELOW GRADE EXPOSED ON BUILDING EXTERIOR TO ROOF. PAINT CONDUIT TO MATCH THE SURROUNDING SURFACE. PROVIDE WEATHER HEAD FOR TRANSITION FROM CONDUIT ON BUILDING TO POLE.
- PROVIDE WEATHER HEAD FOR TRANSITION FROM CONDUIT ON BUILDING TO POLE. ROUTE CABLES INTO PULL BOX. PULL BOX SHALL HAVE SUFFICIENT CONDUIT SLEEVES INTO BUILDING CEILING SPACE TO ACCOMMODATE ALL CABLES.
- PROVIDE AERIAL RATED CABLES ATTACHED TO MESSENGER WIRE FOR THE FOLLOWING LOW VOLTAGE SYSTEMS: LAN, INTRUSION, PA/CLOCK, FIRE ALARM. MAINTAIN MINIMUM SEPARATION FROM POWER CONDUCTORS AND CLEARANCE FROM FINISHED GRADE PER SEC SECTION 229.66.
- EXISTING POWER SYSTEM PULLBOX TO REMAIN PROTECTED IN PLACE.
- INTERCEPT EXISTING CONDUIT AND CONDUCTORS IN EXISTING PULL BOX AND EXTEND AS INDICATED. VERIFY EXACT LOCATION IN FIELD.
- EXISTING CONDUIT AND CONDUCTORS FEEDING DISTRIBUTION PANEL "PDPs"; TO DISCONNECTED AND REMOVED. VERIFY EXACT LOCATION IN FIELD.
- EXISTING CONDUIT AND CONDUCTORS TO REMAIN PROTECTED IN PLACE. VERIFY EXACT LOCATION IN FIELD.
- EXISTING CONDUIT AND CONDUCTORS FEEDING EXISTING DISTRIBUTION PANEL "PDPs" TO REMAIN PROTECTED IN PLACE. VERIFY EXACT LOCATION IN FIELD.

SITE UTILITY PLAN CONSTRUCTION NOTES:

- THESE NOTES ESTABLISH MINIMUM QUALITY LEVELS AND COORDINATION REQUIREMENTS RESPECTIVE UTILITY COMPANY PLANS AND REQUIREMENTS TAKE PRECEDENCE OVER THESE NOTES WITH REGARD TO RESPECTIVE UTILITY COMPANY CONDUIT AND UNDERGROUND STRUCTURE SYSTEMS.
- CALL UNDERGROUND SERVICE ALERT (USA) AT (800) 422-4133 OR APPLICABLE STATE AND LOCAL DIG SAFE OR UNDERGROUND ALERT HOTLINES PRIOR TO CONSTRUCTION START.
 - COORDINATE ALL UNDERGROUND STRUCTURES AND CONDUIT ROUTING WITH LANDSCAPE ARCHITECT PRIOR TO ROUGH-IN TO ENSURE THAT SUCH ITEMS ARE NOT PLACED IN CRITICAL LANDSCAPE PLANTING/HARDSCAPE AREAS.
 - VAULTS, MAINTENANCE HOLES (MH'S), FORMERLY KNOWN AS MANHOLES, AND CONDUITS SHALL MAINTAIN A MINIMUM COVER OF 24" BELOW FINAL SURFACE AT ALL CONDITIONS. INCLUDE ALL COSTS IN BASE BID TO MEET UTILITY COMPANY REQUIREMENTS WHICH MAY REQUIRE GREATER MINIMUM CONDUIT DEPTHS.
 - VAULTS, MH'S AND PULLBOXES (PB'S) SHALL BE EQUIPPED WITH KNOCKOUT PANELS OR PRE-CAST INDIVIDUAL CONDUIT OPENINGS. CONDUITS SHALL ONLY ENTER AND EXIT ON END/SHORT WALLS. CONDUITS MAY NOT ENTER AND EXIT ON SIDE/LONG WALLS, CEILINGS OR FLOORS UNLESS OTHERWISE NOTED.
 - CUT DUCTS FLUSH WITH INTERIOR VAULT/MH/PB WALL.
 - GROUT AROUND DUCT ENTRANCES ON VAULT/MH/PB WALLS.
 - SLURRY BACKFILL AROUND DUCTS WITHIN 5 FEET OF VAULT/MH/PB TO PREVENT SHEARING.
 - CONDUITS PASSING UNDER THE BUILDING PERIMETER SHALL BE ENCASED IN LIGHTWEIGHT CONCRETE OR WATER-IMPERVIOUS CLAY TO PREVENT WATER INFILTRATION. SEE ELECTRICAL SPECIFICATIONS FOR ADDITIONAL INFORMATION.
 - CONDUIT BEND RADIUS FOR BUILDING ENTRANCES AND AT POLES SHALL BE A MINIMUM OF 24" FOR CONDUITS WITH LESS THAN 2" INTERNAL DIAMETER AND A MINIMUM OF 48" FOR CONDUITS WITH MORE THAN 2" INTERNAL DIAMETER.
 - PREFEERED CONDUIT SWEEP RADIUS BETWEEN VAULTS IS 25 FEET. UNDER NO CIRCUMSTANCES SHALL THE CONDUIT SWEEP RADIUS BE LESS THAN 12.5 FEET. MAXIMUM OF 90 DEGREES PER SWEEP AND LIMITED TO NO MORE THAN (2) 90 DEGREE SWEEPS BETWEEN VAULTS.
 - VAULTS/MH's/PB's ARE TO BE EQUIPPED WITH RACKING, GROUNDING LUGS, AND BOLT-DOWN LIDS UNLESS OTHERWISE NOTED.
 - VAULTS AND MH's TO BE EQUIPPED WITH ROUND COVERS, EXTENSION RINGS AS REQUIRED, LADDERS AND (3) SEGMENTS OF 6 FOOT HIGH CABLE RACKING PER EACH LONG WALL.
 - LABEL ALL NON-UTILITY COMMUNICATION VAULT/MH/PB COVERS WITH "COMMUNICATIONS" UNLESS OTHERWISE NOTED ON PLANS.
 - COORDINATE FINAL VAULT/MH/PB OPENING HEIGHT WITH G.C. PRIOR TO ROUGH-IN TO ENSURE FINAL GRADE DOES NOT SLOPE INTO VAULT/MH/PB OPENING.
 - CONTRACTOR TO PROVIDE A MINIMUM OF 8" DEEP COMPACTED 1/2" DIAMETER GRAVEL, UNDER ALL VAULTS, MH'S OR PB'S TO ENSURE UNIFORM DISTRIBUTION OF SOIL PRESSURE ON THE FLOOR AND BE ABLE TO DISSIPATE WATER OUT OF THE VAULT, MH OR PB.
 - ALL VAULTS/MH's/PB's WITHOUT GROUNDING LUGS SHALL HAVE AN 8" x 3/4" COPPER GROUND ROD DRIVEN THRU THE FLOOR TO ALLOW GROUNDING OF ITEMS WITHIN.
 - ALL VAULTS/MH's/PB's SHALL BE PROVIDED WITH TRAFFIC RATED COVERS WHEN LOCATED IN PAVED AREAS UTILIZED FOR VEHICLE TRAFFIC.
 - IF THE WATER OR MOISTURE BARRIER ON OR NEAR THE FOUNDATION OF A BUILDING IS DISTURBED IN ANY MANNER BY EXCAVATION OR OTHER CONSTRUCTION WORK, THE MOISTURE BARRIER MUST BE REPAIRED FOLLOWING THE RECOMMENDATIONS OF THE MANUFACTURER OF THE ORIGINAL BARRIER PRODUCT.
 - THE CONTRACTOR SHALL INCLUDE IN BASE BID ALL COSTS TO COMPLY WITH ALL REQUIREMENTS FOR CONFINED SPACE ENTRY PER THE OSHA REQUIREMENTS 29 CFR-1910.146, 29 CFR-1910.268, ETC. DURING ANY CONFINED SPACE ENTRY.
 - ANY DUCTS LEAVING A VAULT, MH OR PB ROUTED INTO A FACILITY SHALL BE PLUGGED AT EACH END USING REMOVABLE MECHANICAL PLUGS DESIGNED TO PREVENT WATER AND GAS FROM ENTERING THE FACILITY.
 - SEE ELECTRICAL SPECIFICATIONS AND PLAN DETAILS FOR ADDITIONAL REQUIREMENTS REGARDING UNDERGROUND CONDUITS AND IN-GRADE VAULT/MH/PB/JUNCTION BOXES.

SITE ELECTRICAL PLAN

SCALE: 1" = 30'-0"

1

OWNER: NEW HAVEN UNIFIED SCHOOL DISTRICT
PROJECT NAME: Pioneer ES Interim Housing

CLIENT ADDRESS: 32737 BEL AIRE ST., UNION CITY, CA

REVISIONS:

| NO. | DESCRIPTION | DATE |
|-----|-------------|---------|
| ▲▲ | ADDENDUM 5 | 5/29/19 |
| ▲ | | |
| ▲ | | |
| ▲ | | |
| ▲ | | |
| ▲ | | |
| ▲ | | |
| ▲ | | |
| ▲ | | |
| ▲ | | |

DATE ISSUED: 10/08/2018
PROJECT NO: 2018-0621
SCALE: AS INDICATED
SHEET NUMBER: E01.1
SHEET TITLE:

SITE ELECTRICAL PLAN

tkisc
 COLLABORATIVE
 11870 Pierce Street, Suite 160
 Riverside, California 92505
 951.299.4160 www.tkisc.com
 Project Lead: Bill Voller
 Electrical Lead: Andrea Lawson
 tkisc Job #: 2018-0621