

PREBID CONFERENCE SIGN-IN SHEET

RFP#: 1206-18/19 Architectural, Landscape, and Engineering Consulting Services

July 09, 2018 9:00AM @ Marengo West 10 AM

CO. NAME	CONTACT	PHONE	EMAIL	TIME IN	TIME OUT
1 gkkworks	JAVAN NABILI	818-968-1123	JNABILI@CANNON DESIGN.com	9:40	
2 Westberg + White	Kathie Bloomfield	714-508-1780	kbloomfield@wwarch.com	9:41	
3 PDS	TIM POCOCK	949.917-3403	TIM @ POCOCK DESIGN SOLUTIONS.com	9:41	
4 LITTLE	JAY TITTLE	818.451.1314	Jay.tittle@littleonline.com	9:45	
5 MHP, Inc	Terry Fernandez	562-985-3200	terfernandez@mhpse.com	9:45	
6 MHP, Inc	Elise Puritz	562-985-3200	epuritz@mhpse.com	9:45	
7 M LA ARCHITECTURE	MUN LEU	626.283.5996	mleu@mlarchitecture.com	9:50	
8 Gonzalez Goodale Arch	Matt Morseth	626-568-1428	mmorseth@ggArch.com	9:50	
9 DLR Group	Barbara Hass	310.384.9553	bhass@drlrgroup.com	9:45	
10 HMC	VIRGINIA MARQUARDT	213-505-2925	virginia.marquardt@hmcarchitects.com	9:50	
11 HMC	Cindy Lai	(213)542-8800	Cindy.lai@hmcarchitects.com	9:50	
12 IBI Group	Paige Fundament	949-466-2798	paige.fundament@ibigroup.com	9:50	
13 A4E	Emily Hazelwood	626-356-4000	ehazelwood@architecture4e.com	9:55	
14 GST	Michelle Bain	310.283.3164	mbain@gstas.com	9:55	
15 LPA	RICK MUSTO	949-769-6236	RMUSTO@LPAINC.COM	9:56	
16 GGA	STACI NESBITT	626 568 1428	snesbitt@ggarch.com	9:57	
17 WLG	BRUCE OU	909 987 0904	bou@wlcarchitects.com	9:58	
18 GOODALE ARCHITECTURE	DAVID GOODALE	626 379-0758	david@goodalearch.com	9:59	
32 GST	Dave Haack	562-345-8700	dhaack@gstes.com	10:00	

**PREBID CONFERENCE SIGN-IN SHEET**  
**RFP 1206-17/18 Architectural, Landscape, and Engineering Consulting Services**  
**July 9, 2018 @ Marengo West 10:00AM**

Co. Name	Contact	Phone	Email	Time In	Time Out
*** PRINT LEGIBLY ***					
19	JAYSON BOIK	626-636-1038	jboik@icof.net	9:52	
20	EMAD HANDY	ATI	ehandy@atae.com	9:55	
21	IDS GROUP	JACOB TSIMAN	jacob.tsiman@idsgr.com		
22	HED	PRISCILLA REYNADO	preynado@hed.design		
23	ABS CONSULTING	KRISTOF SCHNAITMANN	kschnaitmann@absconsulting.com		
24	HLA LANDSCAPE ARCH.	GREG MEER	gregme@hla.com	9:55	
25	RACHUN PARTNERS	RICHARD INGRASSIA	r INGRASSIA@rachelinpartners.com	10:00	
26	Helena Tibany	NAC Architecture	htibany@nacarchitecture.com		
27	Converse Consultants	Glenn Daniels	gdaniels@converseconsultants.com	10:00	
28	Guidepost Solutions	Tateen Mason	tmason@guidepost-solutions.com	10:01	
29	MATSK	MAY LAU	mlau@take.com	10:00	
30	HPI ARCH.	AMMAR SANSAM	asarsame@hpiarchitecture.com	10:10	
31	Jensen Hughes	Vivien Watts Julia Raman Jr.	jramon@jensenhughes.com	10:10 AM	10:18 AM
32					
33					

1

**Javan Nabili, AIA**  
Principal



T 626.993.2018  
M 818.968.1123  
jnabili@cannondesign.com

155 South Fair Oaks Avenue  
Pasadena, California 91105

gkkworks.com | cannondesign.com

2

**Kathie Bloomfield** CPSM, CAPS II  
Marketing Manager



kbloomfield@wwarch.com  
T 714.508.1780 x325  
F 714.508.1790  
C 949.922.5628

14471 Chambers Rd., Suite 210  
Tustin, CA 92780-6964

Tustin | San Diego | Riverside

www.wwarch.com

3

**Tim Pocock**  
Principal



**Pocock Design Solutions**  
Consulting Engineers

14451 Chambers Road  
Suite 210  
Tustin, CA 92780

(949) 417-3903 Ext: 103  
Mobile: (714) 932-8340

Tim@pocockdesignsolutions.com

www.pocockdesignsolutions.com

4

**Jay Tittle**  
AIA

**STUDIO PRINCIPAL**  
COMMUNITY  
SCHOOLS

jay.tittle@littleonline.com  
949.698.1463 (t) 818.437.7314 (m)  
Little  
1300 Dove Street, Suite 100  
Newport Beach, CA 92660



5

**TERRY FERNANDEZ, S.E., LEED AP BD+C**  
PARTNER  
562.985.3200 P  
562.985.1011 F  
tfernandez@mhps.com



3900 Cover Street  
Long Beach, CA 90808-1773  
www.mhpse.com

*Elise Puritz*  
*epuritz@mhps.com*

**TERRY FERNANDEZ, S.E., LEED AP BD+C**  
PARTNER  
562.985.3200 P  
562.985.1011 F  
tfernandez@mhps.com



3900 Cover Street  
Long Beach, CA 90808-1773  
www.mhpse.com

7

**Mun Leu**  
Principal, LEED

1961 Huntington Dr. Ste 201  
Alhambra, CA 91801  
626.283.5996  
dir 626.407.2124  
mleu@mlarchitecture.com  
www.MLArchitecture.com

**MLARCHITECTURE**

8



**MATTHEW MORSETH**

T: 626.568.1428 EXT. 240  
MMORSETH@GGARCH.COM

**GONZALEZ GOODALE ARCHITECTS**  
135 W GREEN ST #200 PASADENA, CA 91105

9

**Barbara Hass**

Business Development Leader

bhass@dlrgroup.com  
o: 213/444-0279  
m: 213/255-9116



Architecture Engineering Planning Interiors

10. No card

11

12

**Cindy Lai**  
cindy.lai@hmcarchitects.com

**Project Manager**  
633 W. 5th Street, Third Floor  
Los Angeles, CA 90071  
T 213 542 8300  
www.hmcarchitects.com



**Paige Fundament**  
Business Development  
cell +1 949 466 2798  
email paige.fundament@ibigroup.com

**IBI GROUP**  
315 West 9th Street-Suite 600  
Los Angeles CA 90015-4206 USA  
tel +1 213 769 0011 ext 56132 fax +1 213 769 0016  
**ibigroup.com**

IBI GROUP

13

14

15

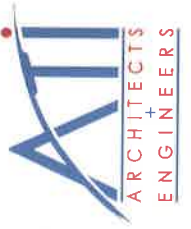

**EMAD HAMDY, R.A.**  
PRINCIPAL ARCHITECT

W 714 338 1600  
M 909 647 5046  
ehamdy@atae.com  
www.atae.com  
www.emilyreusedesign.com



**Michelle Bain**  
*Senior Account Executive*

C. 310.283.3164  
mbain@gstes.com

12881 166<sup>th</sup> Street ■ Cerritos, CA 90703 | www.gstes.com



**Rick Musto, AIA/LEED AP BD+C**  
Associate/Project Director

p. 949.261.1001 m. 949.212.4980  
w. lpainc.com e. rmusto@lpainc.com

5161 California Avenue, Suite 100  
Irvine, California 92617

16

17

18



**STACI NESBITT, AIA**  
LEED AP  
ASSOCIATE PRINCIPAL

T: 626.568.1428 EXT. 203  
M: 323.428.1361  
SNESBITT@GGARCH.COM

GONZALEZ GOODALE ARCHITECTS  
135 W GREEN ST #200 PASADENA, CA 9105



**Bruce Ou**  
Architect, AIA  
LEED™ AP  
Principal

8163 Rochester Avenue, Suite 100  
Rancho Cucamonga, CA 91730

bou@wlcarchitects.com  
t: 909 987 0909  
f: 909 980 9980

DAVID GOODALE AIA

ARCHITECT LEED AP  
DAVID@GOODALEARCH.COM  
626 379 0759

GOODALEARCH.COM

19 attended wrong bid.



Laborers' International Union of North America

# LIUNA!

Laborers Pacific Southwest Regional Organizing Coalition

**JAYSON BAIZ**  
Labor Relations Representative

4399 Santa Anita Ave., Ste. 204  
El Monte, CA 91731  
626-350-9403 office  
626-350-9417 fax  
626-636-1038 cell  
jbaiz@lcof.net  
www.lpswroc.com



20



**EMAD HAMDY, R.A.**  
PRINCIPAL ARCHITECT

W 714 338 1600  
M 909 647 5046  
ehamdy@ataee.com  
www.ataee.com  
www.emilyreusedesign.com

21



IDS Group  
www.idsgj.com

**Jacob Tismanis, PE, WELL AP, LEED AP, CPMP, BCxP**  
Principal - Mechanical Engineering

11845 W. Olympic Boulevard  
Suite 515  
Los Angeles, CA 90064  
323.800.6500 ext. 604  
323.800.6501 fax

jacob.tismanis@idsgj.com

Irvine

San Diego

Los Angeles

22

**Priscilla Reynado**  
Marketing Services

213 542 4554  
preynado@hed.design

601 South Figueroa Street  
Suite 500  
Los Angeles CA 90017

213 542 4500

23



# ABS Consulting

An ABS Group Company

**KRISTOF R. SCHNAITMANN, P.E., S.E.**  
Lead Engineer

300 Commerce Drive, Suite 200  
Irvine, CA 92602-1300 USA  
www.abs-group.com

Direct: 1-714-734-2521  
Fax: 1-714-734-4272  
Email: kschnaitmann@absconsulting.com

24

**RHA**  
LANDSCAPE  
ARCHITECTS  
PLANNERS, INC.

Greg Meek, RLA  
Principal

6800 Indiana Avenue, Suite 245  
Riverside, California 92506  
951-781-1930 Ext. 122  
951-686-8091 fax  
gregm@rhala.com  
www.rhala.com

25

**Richard Ingrassia, AIA, LEED AP**  
Partner

8640 National Boulevard  
Culver City, CA 90232  
310.204.3400

# RACHLIN

PARTNERS

ringrassia@rachlinpartners.com  
rachlinpartners.com

26

# NAC

**Helena L. Jubany, FAIA**  
Managing Principal

P 323 475 8075  
E hjubany@nacarchitecture.com

27



**Converse Consultants**  
Geotechnical Engineering & Consulting  
Environmental & Groundwater Science  
Materials Testing & Inspection Services  
Certified MBE/SBE

**Glenn Daniels**  
Director, Business Development

717 S. Myrtle Avenue  
Monrovia, CA 91016

gdaniels@converseconsultants.com  
http://www.converseconsultants.com

TEL (626) 930-1200  
ext. 259  
FAX (626) 930-1212  
CELL (714) 932-2154

28



Taleen Mason

Business Development Manager  
Security & Technology Consulting

Guidepost Solutions LLC  
707 Wilshire Boulevard, Suite 3850  
Los Angeles, CA 90017  
PI License #27294

D: 213.814.5880  
M: 213.604.7070  
tmason@guidepostsolutions.com

29



MAY LAU ARCHITECT, LEED AP  
Senior Project Manager

213.614.0900 | m.lau@tska.com | www.tska.com  
888 south Figueroa street, suite 2020 | los angeles, california 90017

30

AMMAR SARSAM

Architect, NCARB, LEED AP (BD+C)  
Principal | Operations



6020 Cornerstone Court West, Suite 260  
San Diego, CA 92121  
858.203.4999  
asarsam@hpiarchitecture.com

ARCHITECTURE PLANNING INTERIORS

30

JULIA JONES

LEED GA | AIA Associate  
Associate

115 22nd Street  
Newport Beach, CA 92663  
o 949.675.6442 c 949.701.2389  
jjones@hpiarchitecture.com



ARCHITECTURE PLANNING INTERIORS

31



JENSEN HUGHES

Advancing the Science of Safety  
1000 Wilshire Boulevard  
Suite 250  
Los Angeles, CA 90017

Julian Ramon Jr.  
Associate

O: +1 213-412-1400  
M: +1 213-321-9981  
jramon@jensenhughes.com  
jensenhughes.com

ENGINEERS | CONSULTANTS | SCIENTISTS

32



Dave Haack  
Solution Architect

12881 166th Street  
Cerritos, CA 90703

Dir: 562.345.8741  
Tel: 562.345.8700  
Fax: 562.345.8714  
dhaack@gstes.com

www.gstes.com