

1. DOWNLOAD THE APP

- Search “Campus Eye” in the App Store or Google Play
- Accept invitations for location services, access to camera and push notifications

2. SIGN UP

- Enter sign-up code: **7B82**
- Tap blue Sign-up bar

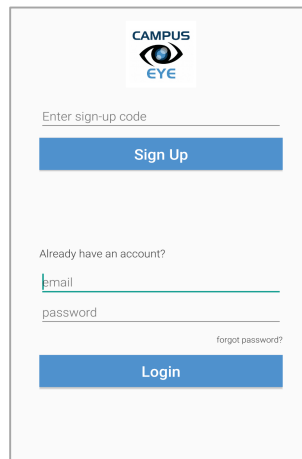

3. CREATE YOUR ACCOUNT

- Enter your name, email and password for accessing your Campus Eye account
- Select the School you wish to be associated with
- Tap Done
- Review and accept the End User Agreement and Privacy Policy

Stay logged in to your Campus Eye app for quick, easy access

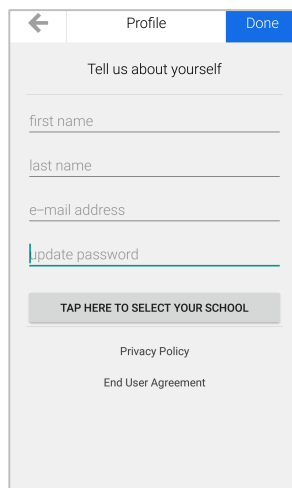

4. CREATE & SEND REPORTS

- Tap the Report Bar for which you want to create a report
- Answer report questions (if applicable)
- Enter report detail
- Tap the camera icon to attach up to 3 pictures and/or a 10-second video
- Tap Anonymous toggle button to send report anonymously (optional)
- Tap blue Send bar
- For Emergencies, tap the red “911” button in the top right corner

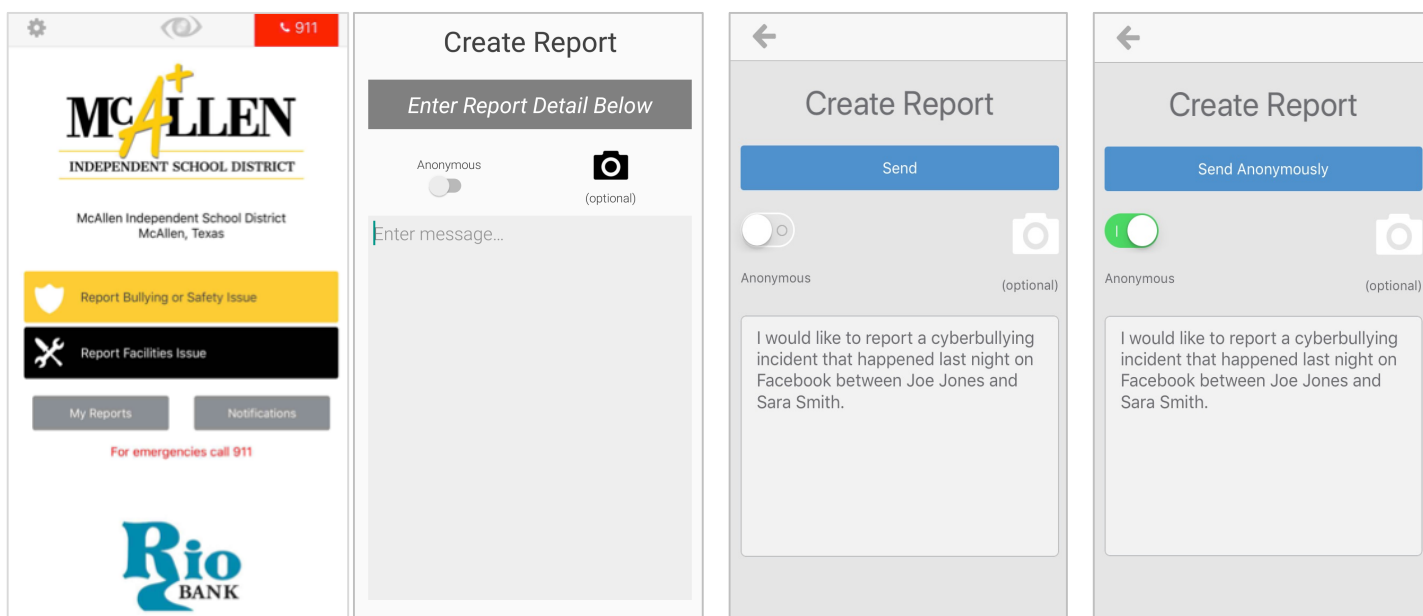

5. MANAGE YOUR REPORTS & NOTIFICATIONS

- Tap My Reports to view reports you have submitted and to check their status
- Tap Notifications to view status updates and alerts sent by your school *

**Notifications section is where you will engage in Chat sessions with the School if needed*



Follow Campus Eye on Social Media