



**Career Technical Education (CTE) & Community College Dual Enrollment Classes**  
**SPRING 2019 SCHEDULE for After School Classes**  
**Starts January 14, 2019 - Ends May 15, 2019**



Class	Credits	Site	Room	Days	Time	Adult Material Fees
<b>Video Game Design</b>	5	AHS	A-25	T W Th	3:15-5:15	
<b>Building &amp; Construction</b>	5	SGHS	IA-3	M W	3:15-6:15	\$75
<b>Emergency Medical Technician</b> (must be 18 years old)	10	SGHS	MS-9	M T W Th	5:30-8:30	\$600
<b>Heating, Ventilation, Air Conditioning</b> (HVAC 2)	5	SGHS	IA-2	T Th	3:15-6:15	\$75
<b>Welding</b>	5	SGHS	IA-4	T Th	3:15-6:15	\$75

**Community College Dual Enrollment Classes (High School Students Only)**

Class	Units	Site	Room	Days	Time	College
Engineering Design Graphics <b>Rio Hondo classes will begin on 1/14/2019</b>	ENGT 122 3 (optional: 5 credits)	MKHS	D107	M W	3:15-6:10	Rio Hondo
*Creative Experience for Children	CH DEV 3	AHS	A20	Th	3:15-6:45	ELAC*
*Public Speaking #	COMM 101	AHS	B13	W	3:15-6:45	ELAC*
*Engineering Graphics w/ Geometric Dimensioning & Tolerancing	EDG TEK 101	AHS	IA 2	T Th	3:15-5:30	ELAC
*The Government of the US #	POL SCI 1	AHS	B13	T	3:15-6:45	ELAC*
*Intro to Robotics	MIT 220	AHS	A32	T Th	3:15-5:30	ELAC*
*Intro to Sociology #	SOC 1	AHS	B13	Th	3:15-6:45	ELAC*
*Concept of Criminal Law	ADM JUS 2	MKHS	A149	T	3:15-6:45	ELAC*
*Public Speaking #	COMM 101	MKHS	A147	Th	3:15-6:45	ELAC*
*The Government of the US #	POL SCI 1	MKHS	A147	W	3:15-6:45	ELAC*
*Intro to Sociology #	SOC 1	MKHS	A147	T	3:15-6:45	ELAC*
*Social Media	CAOT 153	SGHS	B4	W	3:15-6:45	ELAC*
*Public Speaking #	COMM 101	SGHS	B4	T	3:15-6:45	ELAC*

\* ELAC classes will begin on 2/4/2019 # ECP students have priority. See CTE Advisor for details

**REGISTRATION INFORMATION**

**HIGH SCHOOL ENROLLMENT**

High School enrollment begins **December 3, 2018**

Students should see their CTE Advisor or Technician at their high school College & Career Center.

**ADULT ENROLLMENT**

Adult enrollment begins **December 10, 2018**

Adults may enroll at the following location:

<b>Mark Keppel High School</b>	Monday, Wednesday, Thursdays	3-4:30PM
<b>Alhambra High School</b>	Tuesday, Wednesday, Thursdays Week of January 8 <sup>th</sup>	3-4:30PM
<b>San Gabriel High School</b>	Tuesday, Wednesday, Thursdays	3-5:30PM
	Tuesday, Wednesday, Thursdays	3-4:30PM

- A \$50.00 Adult registration fee is required per class.
- **All fees must be paid in full before a student attends class.**
- Money Orders for Registration Fees and Material Fees are expected and may be purchased at Banks, Supermarkets, 7 Elevens or Post Offices.
- **No Cash, Personal Checks or Credit Cards will be accepted.**
- **Fees are not refundable unless a course is cancelled.**

For more information, please call (626) 943-6990

Oral translation of this schedule can be provided in Chinese and Spanish, upon request, but all classes are taught in English.  
 For Chinese call (626) 943-6991 and for Spanish (626) 943-6980.

**Classes with low enrollment may be closed. Classes are subject to change.**

# CTE Course Descriptions

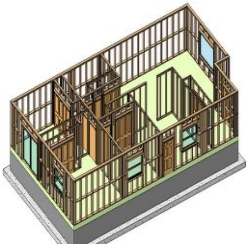

## **Building & Construction**

This course will integrate skills and concepts from the Building and Construction Trades with applied mathematics and English skills. Students will apply the craft skills required to design and build a variety of scaled structures that meet current code requirements. Students will have opportunity to apply academic knowledge and technical skills through a hands on curriculum that meets pre-apprenticeship requirements for the National Building Trades Council.



## **Emergency Medical Technician (EMT)**

This course trains students as ambulance attendants, emergency room attendants, first aid attendants or as part of an entry level class for firefighter positions. This course aligns with the National DOT Curriculum of EMT and meets state and local requirements for course approval. Upon successful completion of this course, students are eligible to apply for National Registry Testing and state certification. Testing and certification fees are the responsibility of the applicant. This course includes classroom instruction, lab and required unpaid community site training. Student needs to either be 18 years old when class starts OR 18 years old by 3/1/2019 if have taken EMR previously.

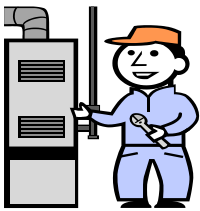

## **Heating Ventilation and Air Conditioning (HVAC)**

This competency based course prepares students for entry level positions as helpers for the technicians who install, maintain and repair heating, ventilation and air conditioning apparatus and equipment. This course prepares students for the HVAC apprenticeship entrance exams.



## **Video Game Design 4**

This course is an advanced comprehensive, self-contained, fully-computer integrated one year course with a final project. It provides specific coverage of the technological and creative aspects of video game design. This course utilizes project-based learning to develop 2D and 3D PC and web games.



## **Welding 2**

Students will learn the safety of working in a welding shop. Also students will learn how to safely operate an Oxy-Acetylene torch. Students first learn safety and proper setup and preparation for fusing metals of many different types together, cutting and project preparation, shaping fitting and setup for proper assembly. Also the students will learn SMAW / Arc Welding fundamentals, welding machine setup, proper welding rod for the job and different position welding, safety and project base learning. Mig and Tig welding basics will be covered and prepare students for advanced welding skills. Class will include theory of welding, bookwork and skills questioning, blueprint reading and drawing, welding symbols, and project base skills building, industry exploration of welding job of all ty pes, employment skills building.

### **EQUAL OPPORTUNITY – AFFIRMATIVE ACTION EMPLOYER**

The Alhambra Unified School District is an equal opportunity employer, and is committed to an active Nondiscrimination Program. It is the stated policy of the Alhambra Unified School District that harassment is prohibited and that all students, employees, and applicants shall receive equal consideration and treatment regardless of Sex, Race, Ancestry, Religion, Creed, National Origin, Physical Disability (including HIV and AIDS), Mental Disability, Medical Condition (Cancer related), Age (over 40), Marital Status, and Denial of Family Care Leave. Inquiries regarding compliance with the employment policy or uniform complaint procedure should be directed to Assistant Superintendent, Human Resources, at (626) 943-3060, or the Office for Civil Rights, Region IX, 780 Market Street, Room 700, San Francisco, CA 94102.