

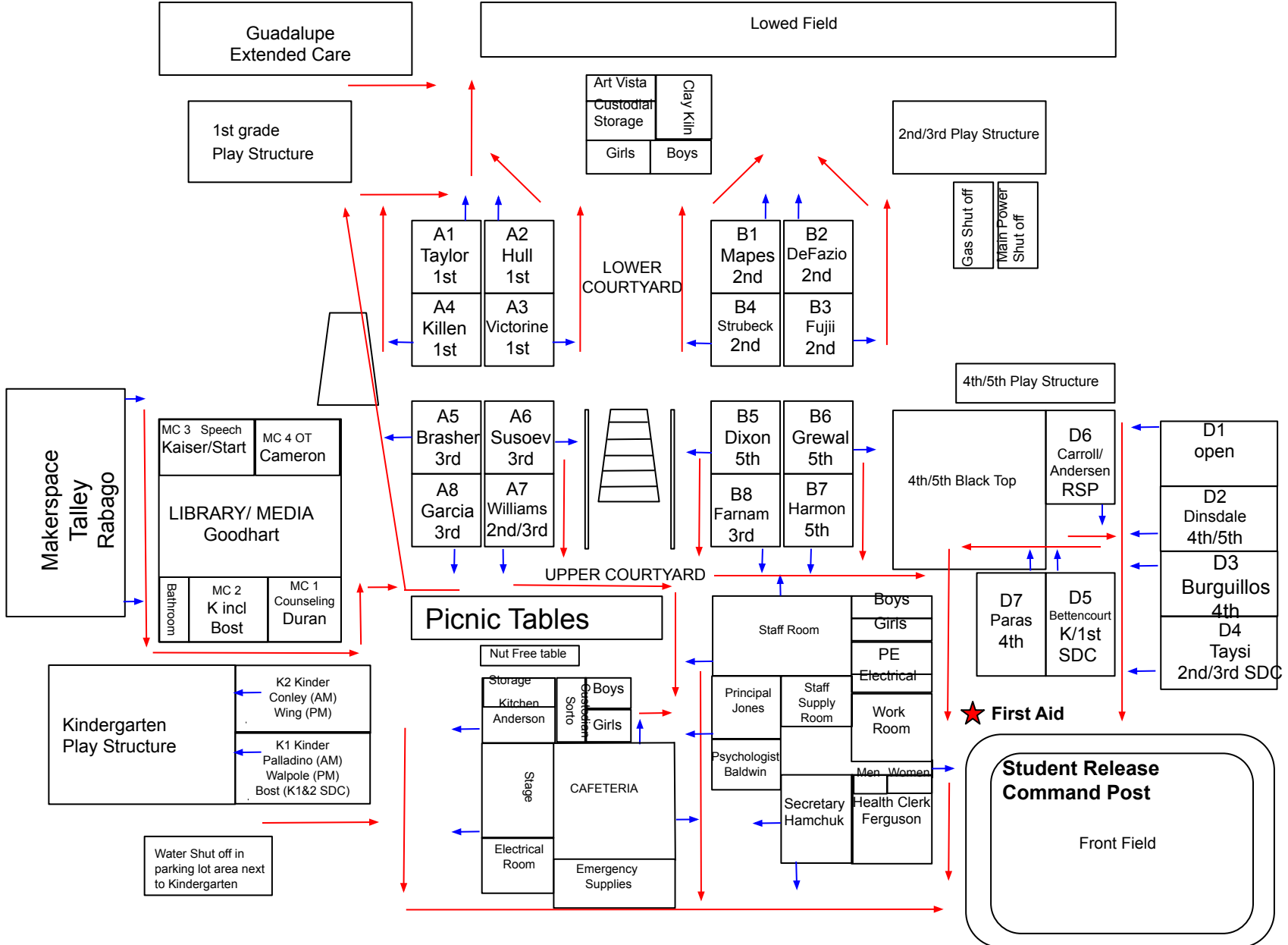

GUADALUPE ELEMENTARY SCHOOL MAP



Guadalupe
Extended Care

Lowed Field

1st grade
Play Structure

| | |
|-------------------|-----------|
| Art Vista | Clay Kiln |
| Custodial Storage | |
| Girls | Boys |

2nd/3rd Play Structure

| |
|---------------------|
| Gas Shut off |
| Main Power Shut off |

| | |
|---------------|------------------|
| A1 Taylor 1st | A2 Hull 1st |
| A4 Killen 1st | A3 Victorine 1st |

LOWER COURTYARD

| | |
|-----------------|----------------|
| B1 Mapes 2nd | B2 DeFazio 2nd |
| B4 Strubeck 2nd | B3 Fujii 2nd |

4th/5th Play Structure

| | |
|----------------|---------------------|
| A5 Brasher 3rd | A6 Susoev 3rd |
| A8 Garcia 3rd | A7 Williams 2nd/3rd |

| | |
|---------------|---------------|
| B5 Dixon 5th | B6 Grewal 5th |
| B8 Farnam 3rd | B7 Harmon 5th |

4th/5th Black Top

| |
|----------------------|
| D1 open |
| D2 Dinsdale 4th/5th |
| D3 Burguillos 4th |
| D4 Taysi 2nd/3rd SDC |

| |
|--------------------------|
| D6 Carroll/ Andersen RSP |
|--------------------------|

| | |
|--------------------------|-----------------------|
| MC 3 Speech Kaiser/Start | MC 4 OT Cameron |
| LIBRARY/ MEDIA Goodhart | |
| Bathroom | MC 2 K incl Bost |
| | MC 1 Counseling Duran |

UPPER COURTYARD

Picnic Tables

| | |
|------------|------------|
| Staff Room | Boys |
| | Girls |
| | PE |
| | Electrical |
| | Work Room |

| | |
|--------------|--------------------------|
| D7 Paras 4th | D5 Bettencourt K/1st SDC |
|--------------|--------------------------|

★ First Aid

| | |
|-----------------------------|---|
| Kindergarten Play Structure | K2 Kinder Conley (AM) Wing (PM) |
| | K1 Kinder Palladino (AM) Walpole (PM) Bost (K1&2 SDC) |

| | | |
|-----------------|--------------------|-----------|
| Nut Free table | | |
| Storage | Kitchen Anderson | Boys |
| | | Girls |
| Stage | CAFETERIA | Men Women |
| Electrical Room | Emergency Supplies | |

| | |
|----------------------|-----------------------|
| Principal Jones | Staff Supply Room |
| Psychologist Baldwin | Secretary Hamchuk |
| | Health Clerk Ferguson |

Student Release Command Post

Front Field

Water Shut off in parking lot area next to Kindergarten